

A

B

C

D

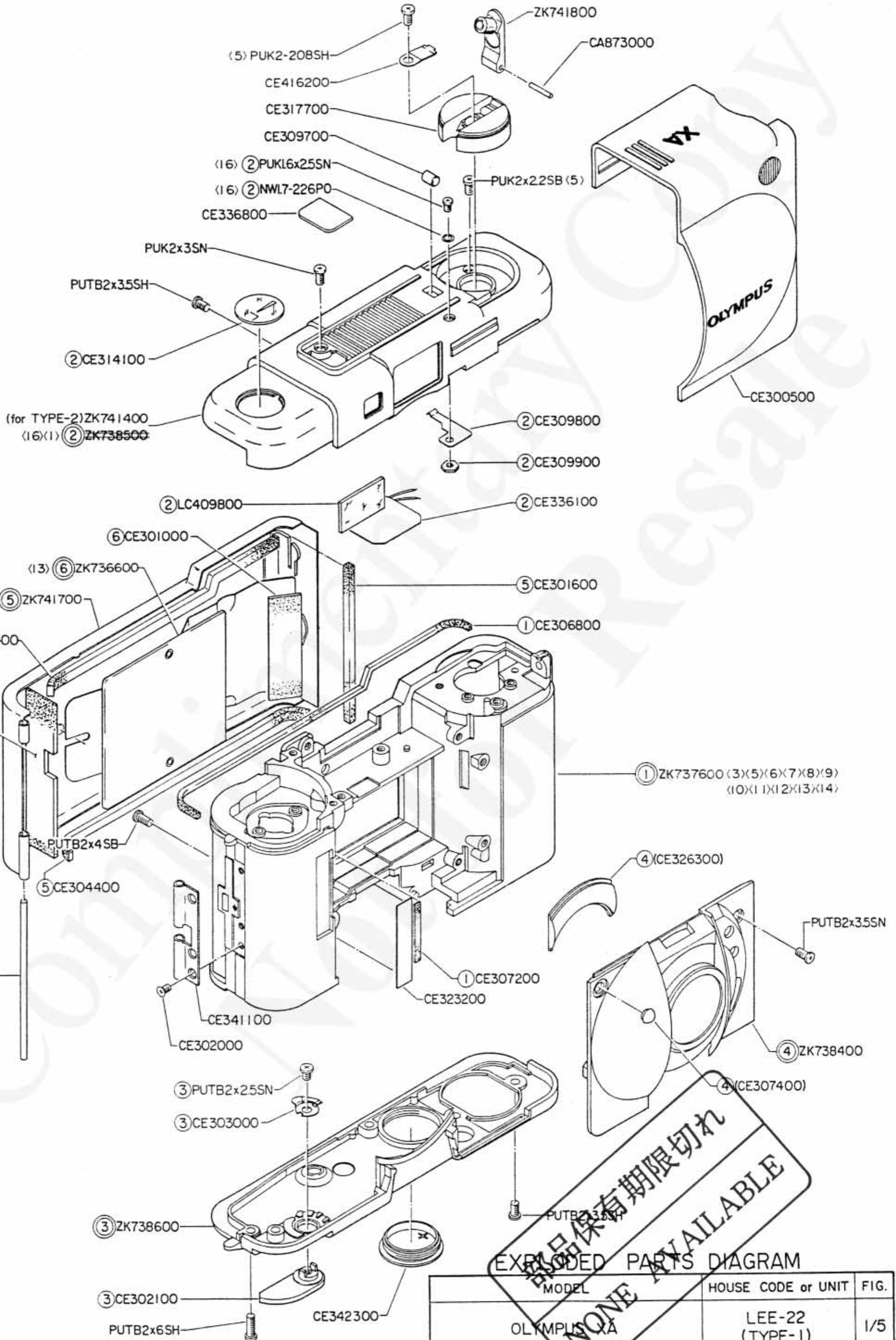

部品保有期限切れ
 NONE AVAILABLE
 EXPLODED PARTS DIAGRAM

MODEL	HOUSE CODE or UNIT	FIG.
OLYMPUS XA	LEE-22 (TYPE-1)	1/5
OLYMPUS OPTICAL CO., LTD. TOKYO, JAPAN		

NOTE : WHEN ORDERING FOR SPARE PARTS, PLEASE CLARIFY A MODEL or HOUSE CODE, PARTS NUMBER AND QUANTITY.

A

B

C

D

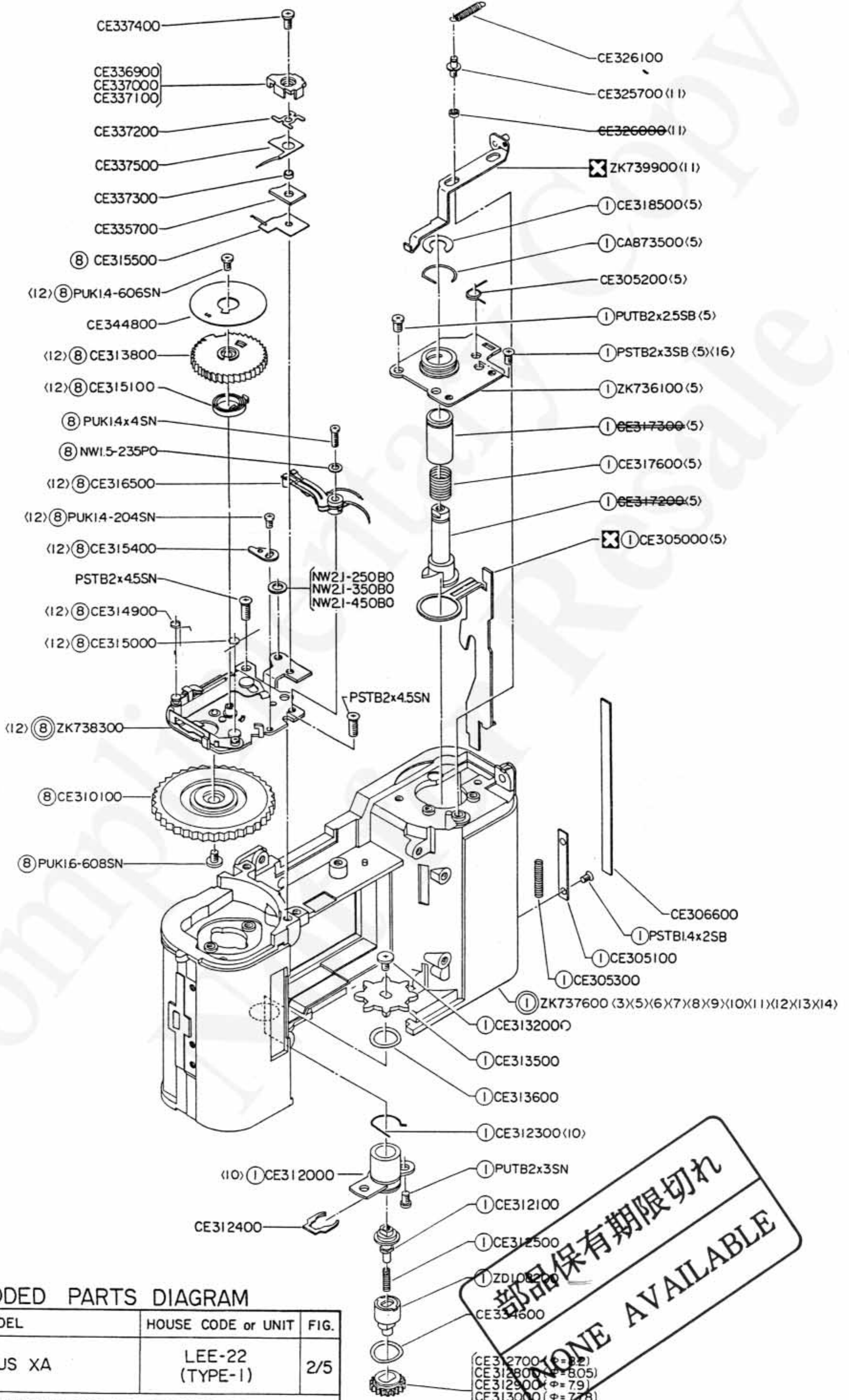

1

2

3

4

EXPLODED PARTS DIAGRAM

MODEL	HOUSE CODE or UNIT	FIG.
OLYMPUS XA	LEE-22 (TYPE-1)	2/5
OLYMPUS OPTICAL CO., LTD. TOKYO, JAPAN		

NOTE: WHEN ORDERING FOR SPARE PARTS, PLEASE CLARIFY A MODEL or HOUSE CODE, PARTS NUMBER AND QUANTITY.

部品保有期限切れ
NONE AVAILABLE

A

B

C

D

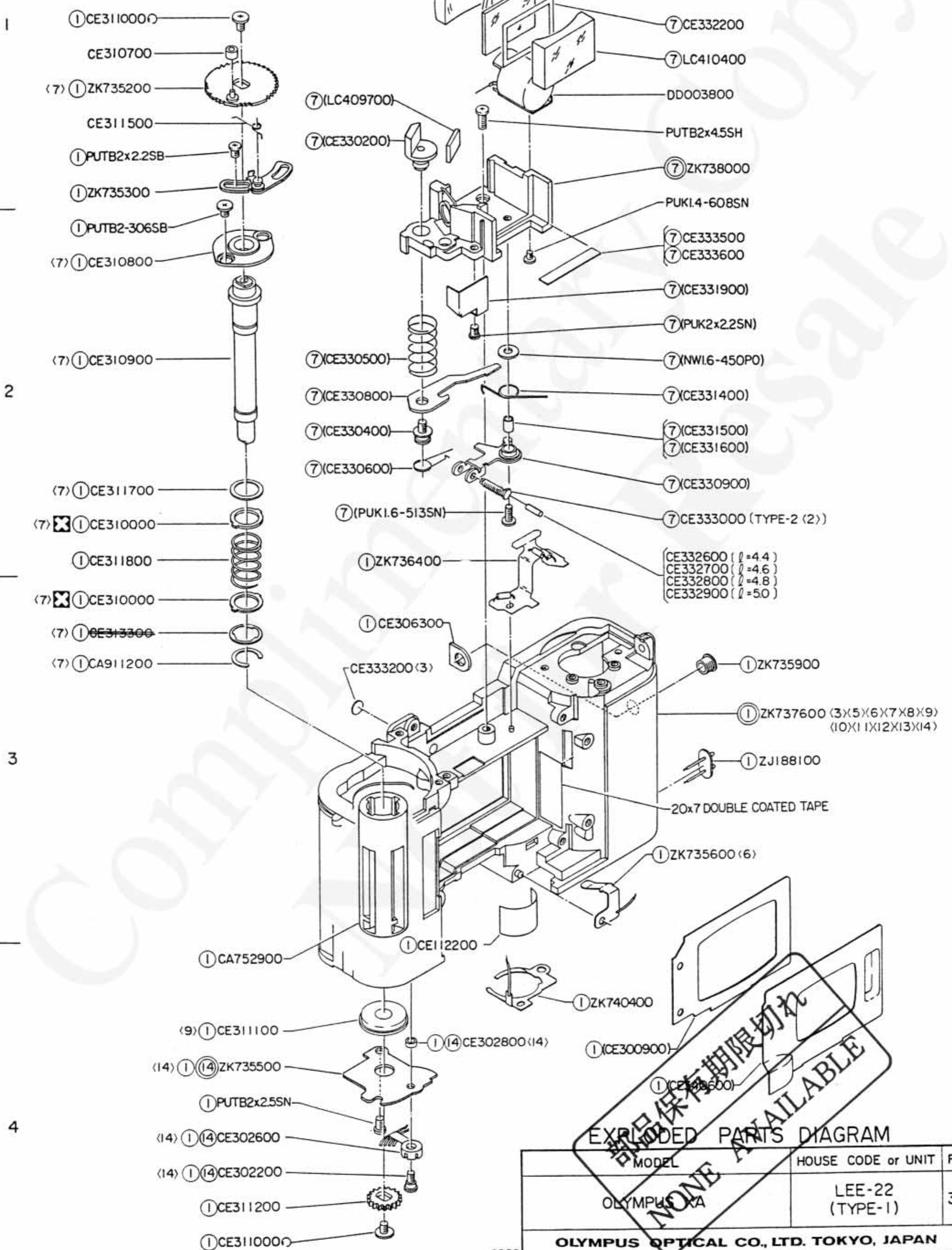

EXPLODED PARTS DIAGRAM

MODEL	HOUSE CODE or UNIT	FIG.
OLYMPUS TA	LEE-22 (TYPE-1)	3/5
OLYMPUS OPTICAL CO., LTD. TOKYO, JAPAN		

NOTE : WHEN ORDERING FOR SPARE PARTS, PLEASE CLARIFY A MODEL or HOUSE CODE, PARTS NUMBER AND QUANTITY.

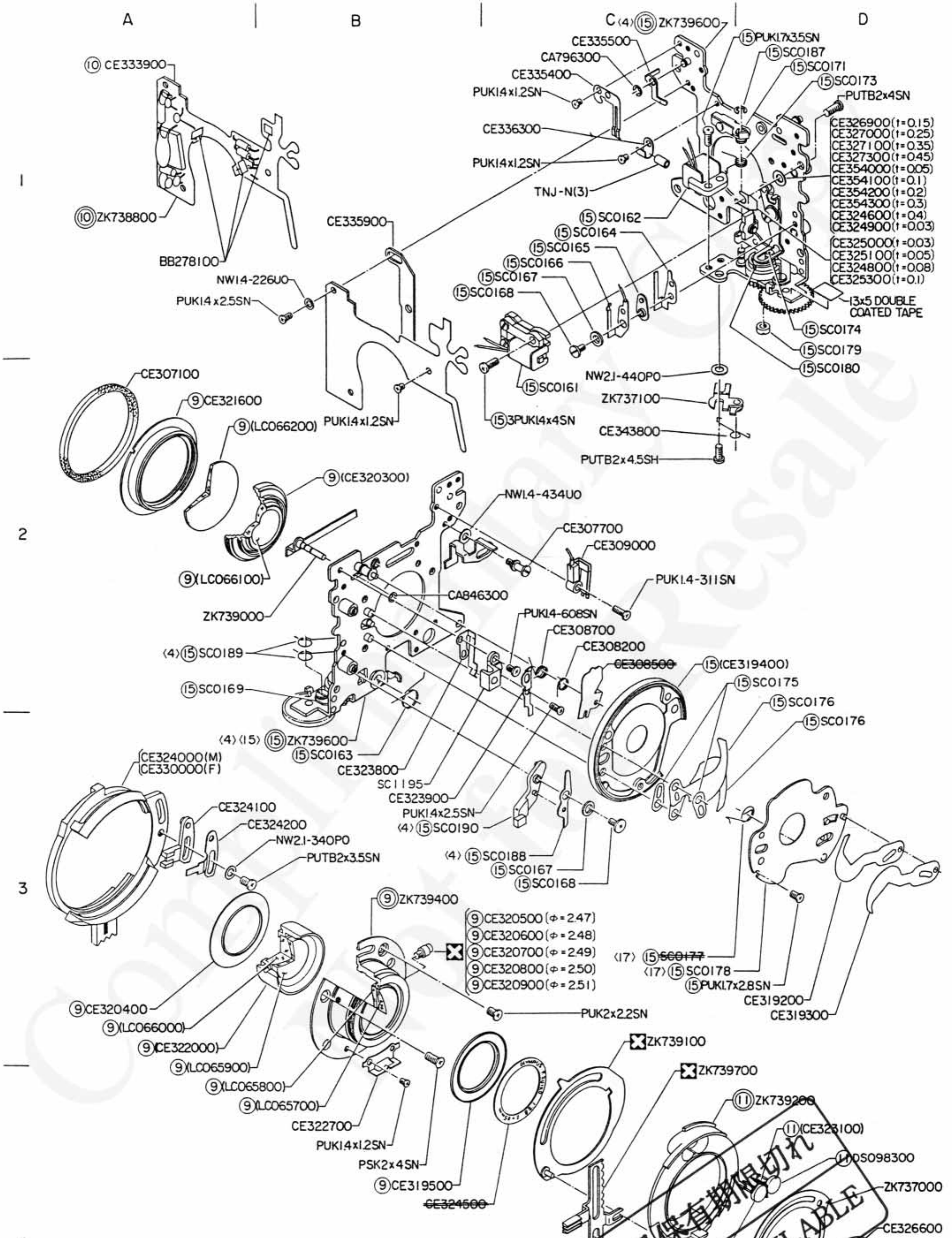

EXPLODED PARTS DIAGRAM

MODEL	HOUSE CODE or UNIT	FIG.
OLYMPUS XA	LEE-22 (TYPE-1)	4/5
OLYMPUS OPTICAL CO., LTD. TOKYO, JAPAN		

NOTE: WHEN ORDERING FOR SPARE PARTS, PLEASE CLARIFY A MODEL or HOUSE CODE, PARTS NUMBER AND QUANTITY.

- CE326900 (t=0.15)
- CE327000 (t=0.25)
- CE327100 (t=0.35)
- CE327300 (t=0.45)
- CE354000 (t=0.05)
- CE354100 (t=0.1)
- CE354200 (t=0.2)
- CE354300 (t=0.3)
- CE324600 (t=0.4)
- CE324900 (t=0.03)
- CE325000 (t=0.03)
- CE325100 (t=0.05)
- CE324800 (t=0.08)
- CE325300 (t=0.1)

- 9 CE320500 (φ = 2.47)
- 9 CE320600 (φ = 2.48)
- 9 CE320700 (φ = 2.49)
- 9 CE320800 (φ = 2.50)
- 9 CE320900 (φ = 2.51)

- (17) 15 SC0177
- (17) 15 SC0178
- 15 PUK17x2.8SN

品切れ
 NONE AVAILABLE
 (11) ZK739200
 (11) CE323100
 (11) OS098300
 ZK737000
 CE326600
 (11) OS030600
 (15) PUK14-608SN

A

B

C

D

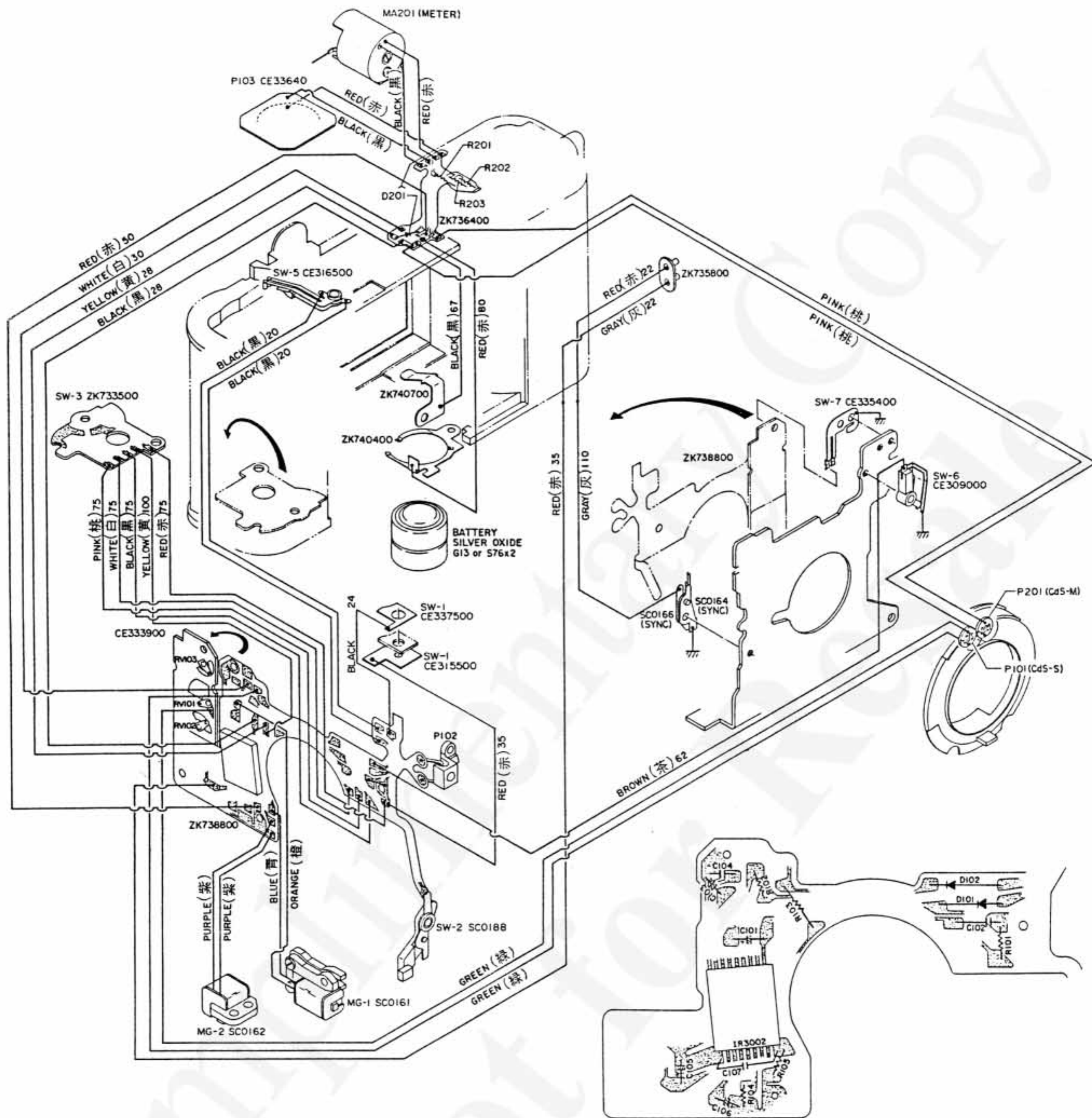

*
 B20K
 56M
 680K

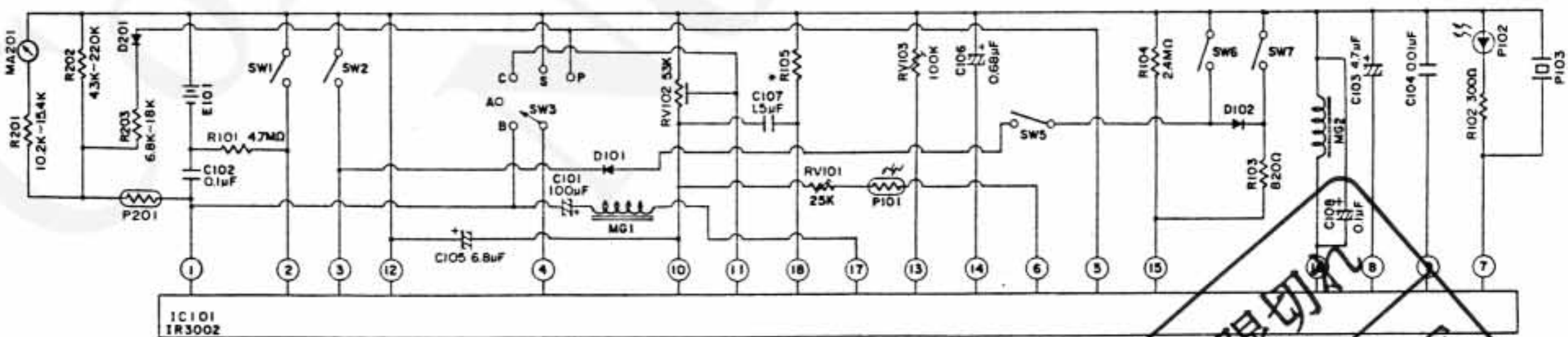

4

EXPLoded PARTS DIAGRAM
 部品保有期限切れ
 NONE AVAILABLE

MODEL	HOUSE CODE or UNIT	FIG.
OLYMPUS	LEE-22 (TYPE-I)	5/5

OLYMPUS OPTICAL CO., LTD. TOKYO, JAPAN

NOTE : WHEN ORDERING FOR SPARE PARTS, PLEASE CLARIFY A MODEL or HOUSE CODE, PARTS NUMBER AND QUANTITY.